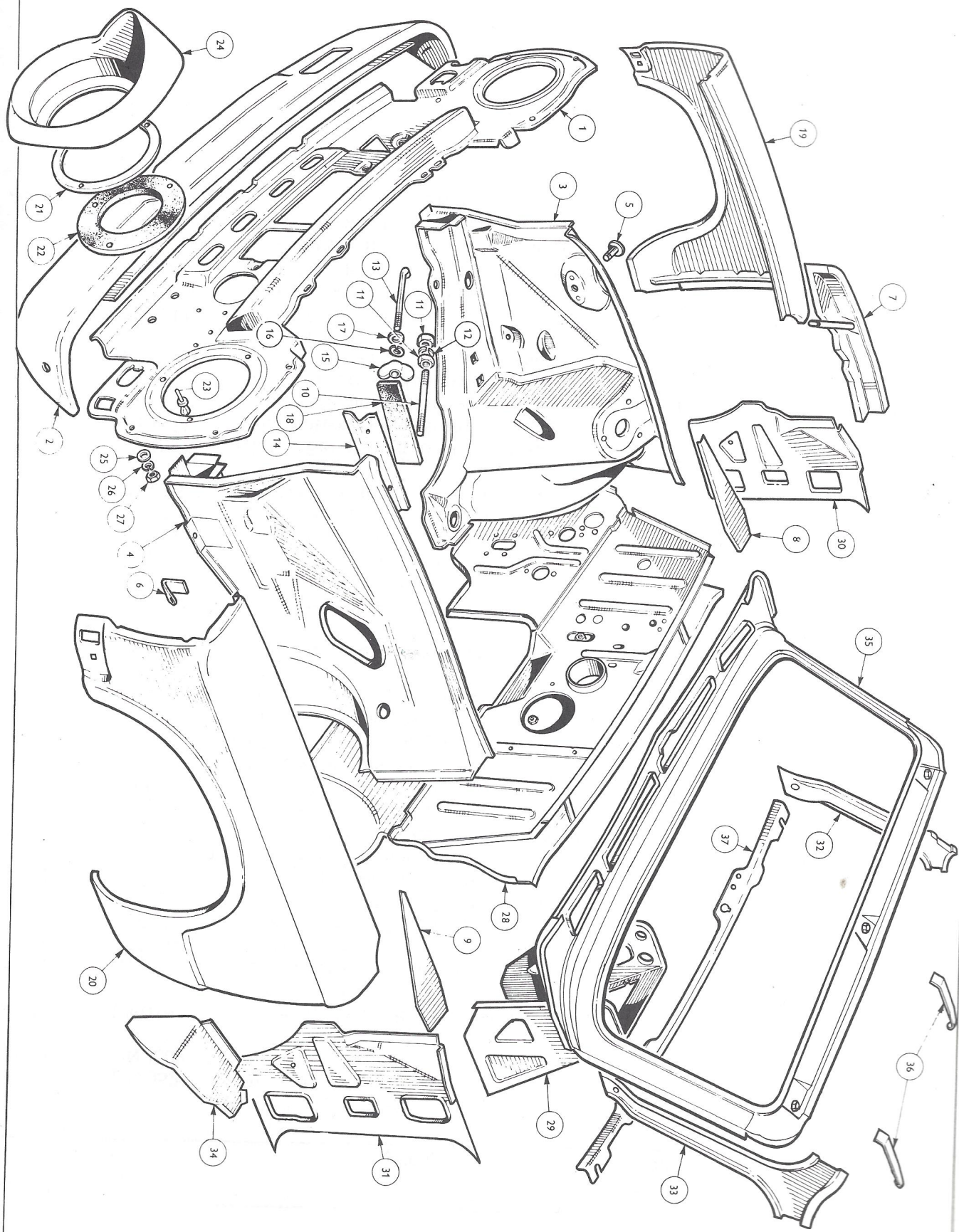

PLATE AK

TRUMPH 1300

81201



BODY AND FITTINGS

Plate No.	Part No.	Description	No. per Unit	Remarks
AK19	808405	FRONT END PANELS - continued	1	
	808404	WING, front, assembly - R.H.	1	
AK20	808404	WING, front, assembly - L.H.	1	
AK21	616883	PLATE, retaining headlamp	2	
AK22	616884	SEAL, headlamp retaining plate	2	
AK23	619101	RIVET, seal to body	6	
	569313	RIVET, pop, headlamp to surround	6	
	904080	SURROUND, headlamp - R.H.	1	
	904079	SURROUND, headlamp - L.H.	1	
AK24	572908	STUD, headlamp surround	8	
AK25	WP0023	WASHER, plain - Headlamp surround to radiator panel and front wing	8	
AK26	WLO207	WASHER, lock - Headlamp surround to radiator panel and front wing	8	
AK27	HN2007	NUT - Headlamp surround to radiator panel and front wing	8	
AK28	904536	PANEL, dash front, assembly - R.H.S. panel and front wing	1	Fitted up to Body Nos. 101357RD (L.H.S.), 106465RD (R.H.S.) only
	904537	PANEL, dash front, assembly - L.H.S.	1	Fitted from Body Nos. 101358RD (L.H.S.), 106466RD (R.H.S.) and future
	909331	PANEL, dash front, assembly - R.H.S.	1	
	909332	PANEL, dash front, assembly - L.H.S.	1	
	618234	PANEL, closing, assembly, dash front	1	
	616905	PANEL, dash front, to closing panel - R.H.	1	
	616904	PANEL, dash front, to closing panel - L.H.	1	
	616895	AIR DUCT assembly, blower to heater component	1	
	619638	REINFORCEMENT, air duct to dash closing	1	
AK29	603559	CLIP, cable harness, dash front assembly	2	
	809443	GEARBOX COVER assembly	1	
	616885	WASHER, accelerator pivot plate, gearbox cover	2	
	603559	CLIP, pipe (Brake and petrol), gearbox cover	2	Fitted up to Body No. 97063RD only

(For future clipping details see pages 72 and 87)

Note:- Items marked thus † are available on our Factory Exchange Unit Scheme